

MINIBOX DIN RAIL



Compact
Easy to assemble
Suitable for managing two micro cables

MINIBOX

DIN RAIL

Entirely made in steel, the optical box is suitable for installation on a DIN bar. It has a capacity of 12 connections with adapter without flange - available separately - SC simplex with shutter, LC duplex, ST or FC.

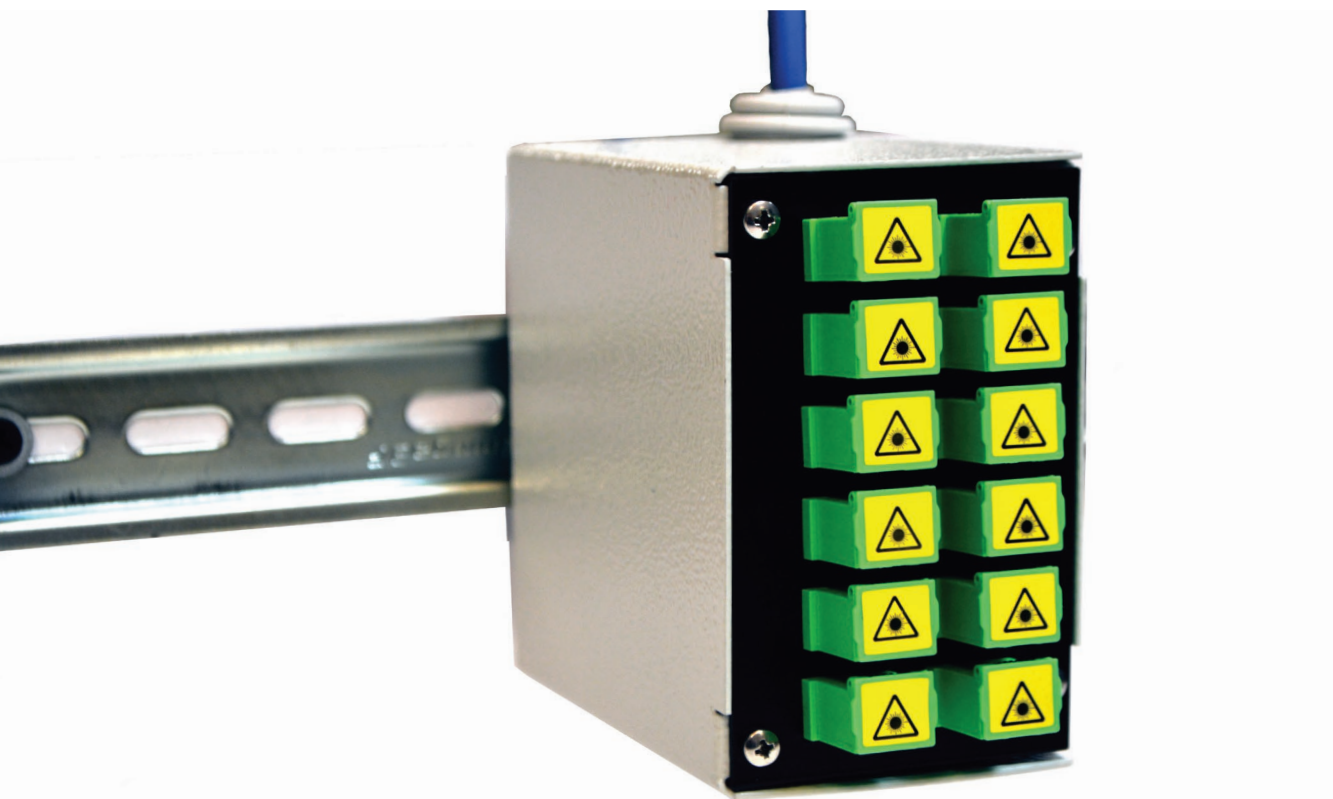

TECHNICAL SPECIFICATIONS

| | | |
|------------------|---------------------------------|-------------------------------|
| MATERIAL | Galvanized steel | |
| DIMENSIONS | 95 x 96 x 61 mm | |
| CABLE INPUTS | 2 | |
| MAXIMUM CAPACITY | 12 positions SC simplex | |
| JOINT HOLDER | Capacity up to 12 joints | |
| JOINT DIMENSION | Ø 2,5 mm | |
| FRONT | SC simplex LC duplex | FC ST |
| COLOR | Base and cover Gray RAL 7035 | Black front panel RAL 9005 |

PRODUCT DETAILS

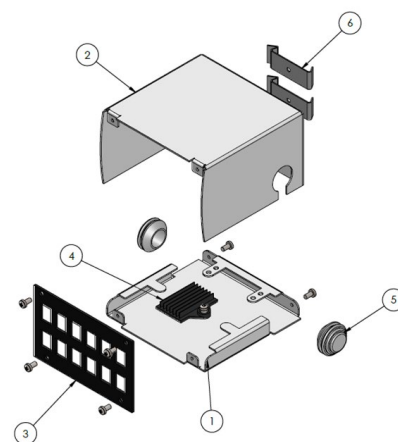

- 1** - Base
- 2** - Cover
- 3** - Front panel
- 4** - Compact 12 FO port holder
- 5** - Cable gland
- 6** - Fastening clip for DIN bar